

Compact Low Cost Booster EDFA (Full Function)

Features/Benefits

- Low cost
- APC, ACC mode
- Low power consumption
- Wide operating temperature range
- Standard communication interface (RS232, I²C)

Applications

- Metropolitan and access networks
- Digital CATV
- Amplet for long-haul network
- Single-channel or DWDM sub-systems
- Optical cross-connects
- Optical add/drop modules
- Amplifier for transmitter line card
- Power equalization and flexible pre-emphasis

Full Function Pin Assignment

Pin	RS-232	I ² C
1	Serial output	Serial bi-di data
2	GND	GND
3	Serial input	Serial clock
4	Alarm status	Alarm status
5	GND	GND
6	Power supply +3.3V	Power supply +3.3V

Safety Information

ESD Protection

The laser diodes and photodiodes in the module can be easily destroyed by electrostatic discharge. Use wrist straps, grounded work surfaces, and anti-static techniques when operating this module. When not in use, the module shall be kept in a static-free environment.

Optical Specifications

Parameters	Unit	Min.	Typ.	Max.
Operating Wavelength Range	nm	1528	-	1562
Input Optical Power (pin)	dBm	- 10	-	0
Total Output Power @ Pin= -6 ~ 0dBm	dBm	8	-	-
		10	-	-
		15	-	-
Noise Figure	dB	-	6	7
Polarization Dependent Gain	dB	-	-	0.5
Polarization Mode Dispersion	ps	-	-	0.5
Return Loss (pump LD off)	dB	35	-	-
Operating Temperature Range	°C	- 5	-	70
Fiber Type	-	SMF-28, 900µm loose tube		
Dimensions	mm	40 x 70 x 12		

Electrical Specifications

Parameters	Unit	Min.	Typ.	Max.
Output Monitor Accuracy	dB	- 0.5	-	+ 0.5
Power Supply Voltage	V	3.1	3.3	3.5
Power Consumption	W	-	-	1.0/1.5*

*1.0W for 8dBm & 10dBm output power options; 1.5W for 15dBm output power option.

Dimensions

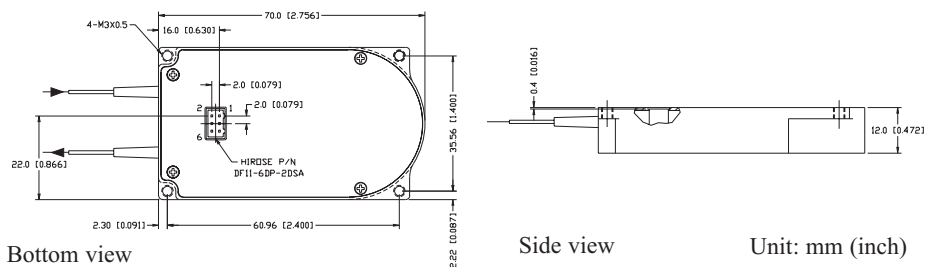

Ordering Information

N	O	A	B	F				0	0	0	1	1	
				Output Power @ Pin= - 6dBm	Default Mode			Electronic Interface			Fiber Length	Connector	
				08= 8dBm	1= APC			R= RS-232			1= 1.0 ± 0.1m	0= None	
				10= 10dBm	2= ACC			C= FC				1= FC/UPC	
				15= 15dBm								2= FC/APC	
												3= SC/UPC	
												4= SC/APC	
												5= LC/UPC	
												6= MU/UPC	
												1= 900µm loose tube	

This product information is subject to change without notice.